

FITTING INSTRUCTIONS

• QUADRANT & OFFSET QUADRANT •



DOOR OPENS OUT. IT IS RECOMMENDED THAT A NON-SLIP MAT IS USED AT ENTRY

IMPORTANT

Thank-you for choosing a MERLYN Series 9 shower door.
Please familiarise yourself with these instructions before installing.

- Do you have all the tools required?
- Is the installation site compatible with the size of door supplied?
- Are all the enclosure components present?
- Is the installation kit complete?

DO NOT attempt to install the product unless you can tick **ALL 4** boxes adjacent as satisfactory.

The wall plugs supplied with the installation kit are for use in solid walls. Hollow or 'stud-partition' walls will require alternative fixings. Please consult a hardware supplier for the correct type.
It may also be necessary to consult your tiling supplier about the correct method for drilling your tiles.

WARNING

HEAVY PRODUCT, ASSISTANCE MAY BE REQUIRED USE SAFETY EYEWEAR WHEN INSTALLING

Any parts missing or damaged must be reported to your supplier within 5 days of purchase. Please state size & colour of product and part number as shown for the corresponding size of door.

INSPECT DOOR BEFORE FITTING NO CLAIMS WILL BE ACCEPTED AFTER THE DOOR HAS BEEN INSTALLED

<< MAJOR COMPONENTS >>



<< FITTING KIT >>

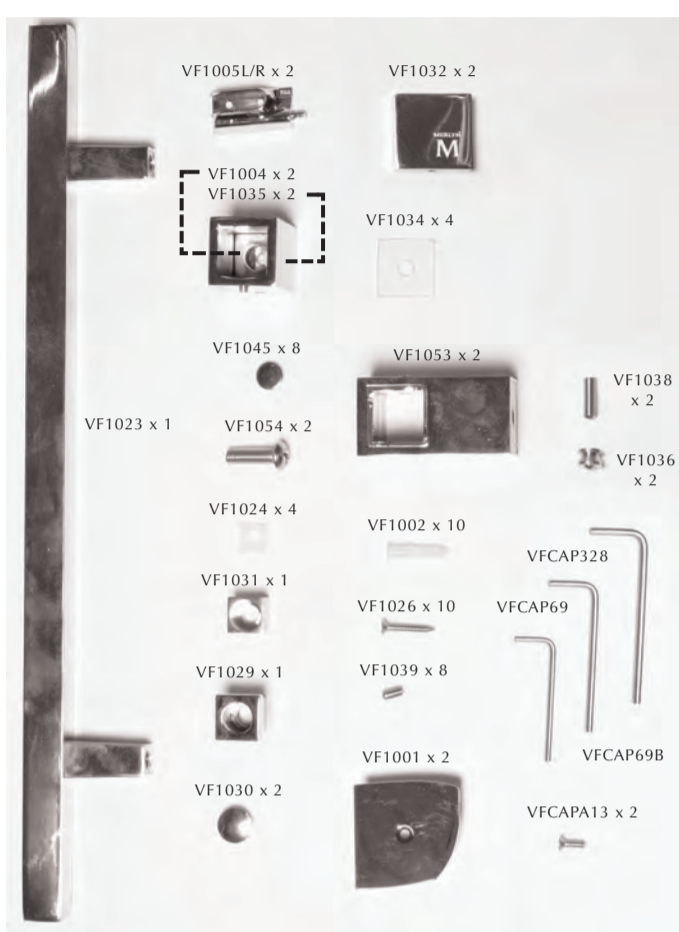

<< TOOLS YOU WILL NEED >>



FITTING INSTRUCTIONS - FOLLOW STEPS IN SEQUENCE

TRAY MUST BE 100% LEVEL IN ALL DIRECTIONS



TRAY MUST BE SEALED TO WALL ALL ROUND

1 Ensure the shower tray is level in all directions and is properly sealed to the wall. The wall must be tiled down to the top edge of the tray. **Do not angle out bottom tile.**

cover slip to inside



2 Remove cover slips VF1007 from wall profiles by sliding a plastic instrument down inside of Cover slip to remove without bending. **NOTE:** If tray finish is close to the minimum, **especially if walls are leaning in**, reduce the step in to the wall profile by **10mm**.

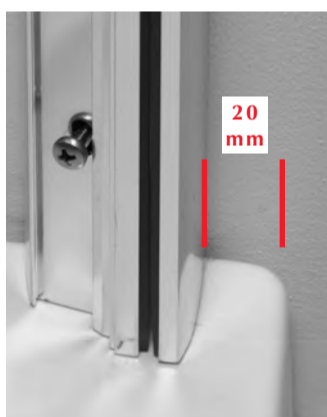

Cover slip to inside



WARNING

Ensure wall profiles are plumb and fixed through the centre of the slot - to allow for later adjustment

3 Place both wall profiles VFCALWUC at 20mm from front edge of shower tray to outside edge of wall profile, plumb, mark & drill holes. Fix both the wall profiles into position with screws VF1026 & plugs VF1002.

inside

loosen



4 Loosen screws on side of wall profiles and slide fixed glass panels into profiles. Tighten middle screw in profile to hold glass.

NOTE: ON OFFSET QUADRANTS, THE HINGE FIXED PANEL GOES ON THE SHORT SIDE OF THE TRAY



5 Add pea size spot of silicone and place foot plate VF1005 under bottom corner of both fixed panels. **GLASS PANEL MUST BE PARALLEL TO FRONT OF TRAY**



6 Hang door onto hinged panel. **TIP** Use hex key VFCAP328 provided to ensure all hinges are tight and square on glass before hanging door.

fixed panel

door panel

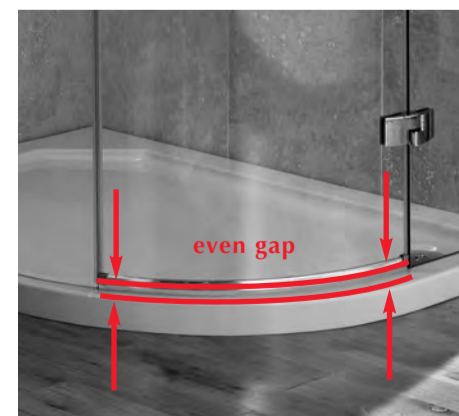
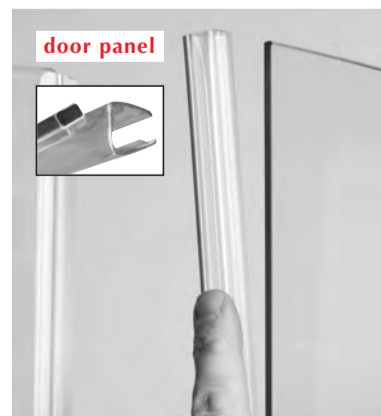

7 Fit magnetic seal VF1056 (with cutout in one end) to front edge of door, angle to inside. **Cut-out section of seal fits into bottom of chrome strip.** Fit the other seal VF1057 with no cutout onto the fixed panel. Angle to the outside. Adjust panel to ensure correct fitting and tighten off profile screws (see step 4) to hold glass in place. Note: Ensure grub screw on fixed panel hinge is tight to pin. Pin should not move. Ensure even gap between top of tray and bottom of door seal along length of door before tightening fixed panel in wall profiles. **TIP** Ensure fixed panels are parallel to the side edge of the tray.

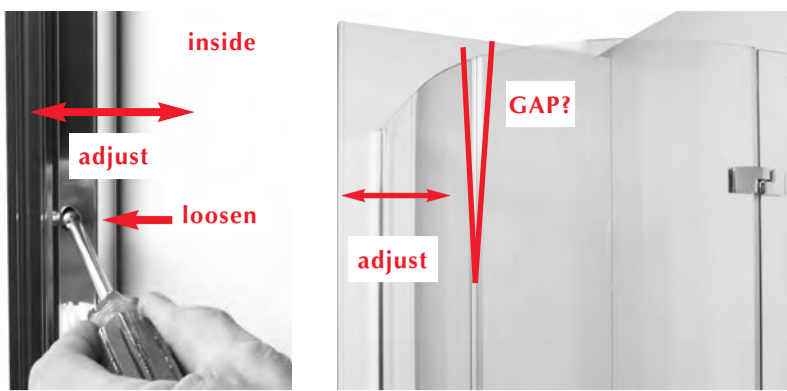

8 If there are any gaps between the magnets at the top or bottom of the fixed and moving panel or they are not level on top, slightly loosen the 4 wall fixing screws for the wall profiles (see step 3) and adjust in or out the TOP of the wall profiles with fixed panels to close the gap. Any minor gap left can be closed when fixing the top rail. It may also be necessary to adjust the glass in and out of the wall profiles.
TIP Ensure magnets meet/door closes before fixing screws in wall profile.



9 **LOOSEN ALL GRUB SCREWS TO AVOID DAMAGE TO RAIL** & slide rail VF1019 through bracket VF1053. Attach rail bracket VF1053 through hole in inline panel using VF1036 & VF1038 ensuring a plastic washer VF1034 is on both sides of the glass.
Note: Rail VF1019 may need to be adapted to size. For 900 x 900 quad reduce longest straight side by 300mm. For 800 x 800 quad reduce longest straight side by 400mm. For 1000 x 800 quad reduce straight side by 200mm

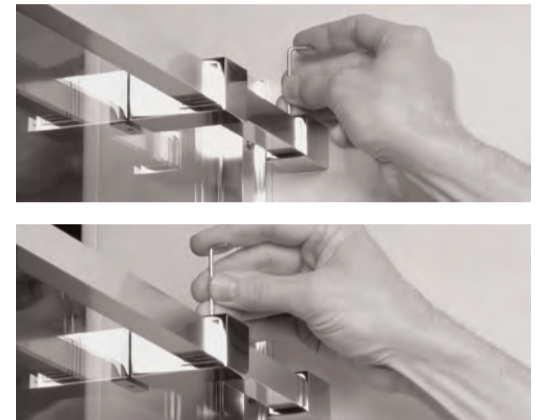

10 Level rail and mark position of ferrule on wall. Remove rail and bracket to allow for fixing of ferrule. Drill and plug hole as required and screw brass ferrule VF1004 to wall. Loosen chrome ferrule cover slip VF1035 and slide onto rail leaving brass ferrule VF1004 on wall. Reposition rail onto fixed panels and wall mount. Adjust to fit and gently tighten grub screws to hold rail in place until final adjustment is completed. **TIP** If there is any remaining gap left between the magnets, fasten the top rail VF1019 to the rail bracket VF1053 on one fixed panel. Then slide the rail in / out of the rail bracket VF1053 on the other fixed panel, and fasten grub screw.



11 Fit cover cap VF1001 to top of wall profile using screw VFCAPA13.

12 Fit web gasket VF1055 to back edge of door, web to inside. **Cut-out section of seal fits into bottom of chrome strip.** Push on hinge screw cover caps VF1045.

13 Fit cover strip VF1007 to inside of wall profile. Note: strip only goes on one way per illustration.

14 Fit handle VF1023/29/31 with screws VF1054 making sure to use plastic washers VF1024 on both sides of glass. Push on screw cover caps VF1030.

15 Fit luna rail VF1008 between footplates VF1005, rail may need adapting to length (adapt side which fixes to hinge fixed panel X). Use a small bead of silicone along underneath of rail to fix rail to tray.

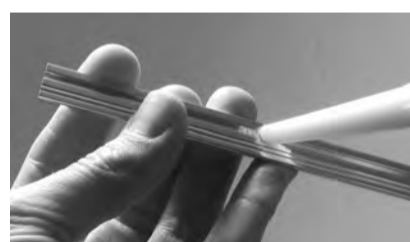

TROUBLE SHOOTING GUIDE

Any fitting issue with the fixed glass panel/door not lining up, or door or not closing correctly, **CHECK THE TRAY, IT MUST BE 100% LEVEL IN ALL DIRECTIONS FOR CORRECT INSTALLATION.**

A Issue: Fixed glass panels are difficult to adjust in and out of the wall profile	Remedy 1: SEE STEP 4: Ensure that all adjusting screws in the wall profile are loosened (not necessary to be removed). TIP: When pushing the glass in and out of the wall profile, angle the glass panel slightly towards the inside of the tray, then adjust in and out of the wall profile, finally straightening back onto tray.
B Issue: Door panel and fixed main panel are not the same level on top	Remedy 1: STEP 7: Ensure the door panel hinges are fully inserted into the fixed panel hinges i.e. Ensure there is not a big gap between the moving panel hinge and fixed panel hinge when door is closed. Remedy 2: STEP 1: Check the tray is level – TRAY MUST BE 100% LEVEL Remedy 3: STEP 4: Adjust the glass panels in and out of the wall profiles - tilting glass upwards and downwards slightly (pulling out at the top or bottom of profile)
C Issue: Gap at the top or bottom between the magnets on the fixed panel and the door panel	Remedy 1: STEP 3: Check that the main fixed panel is square and plumb at the edge Remedy 2: STEP 4: Adjust both fixed panels inwards and outwards to ensure the magnets meet correctly. Remedy 3: STEP 8: Adjust the wall profiles horizontally where they are fixed to the wall either in or out until magnets meet Remedy 4: STEP 10: Adjust the top rail to close the gap by tightening to the bracket (VF1053) with the grub screw on one fixed panel, then sliding the top rail inwards/outwards in the bracket (VF1053) on the second fixed panel
D Issue: Luna Rail (VF1008) not meeting the footplate (VF1005) on the magnetic fixed panel correctly	Remedy 1: Cut very slight angle on Luna rail at end where it joins the magnet fixed panel (C) DO NOT CUT TOO SHORT!
E Issue: When opening the door, the hinge on the door panel rises up but does not sit back down when the door is closed	Remedy 1: STEP 6: Ensure the hinges are square on the moving and fixed glass panels – IF NOT: Remove door from fixed panel then, using hex key provided, adjust hinges to square by first loosening, then re-tightening to correct position on glass panel. Remedy 2: Use lubricant (i.e. Silicone lubricant spray/grease) on the pin and nylon butt.



24 HRS



Seal wall profile to wall on inside from top to bottom. Seal glass/rail to shower tray horizontally on outside only. Seal upright profile to wall from shower tray approx 100mm vertically on outside. Allow unit 24hrs to set. Failure to follow these instructions may invalidate your guarantee.