

SLIDING DOOR

Installation Instructions

Parts and fittings (fig 1) part codes in bold

- | | | |
|--|--|---|
| 1. Wall Profile x 2 BB1201 | 10. Magnetic Upright x 1 BB1103 | X. Upright Profile Cap x 1 BB2106 |
| 2. Wall Plug x 6 BB6204 | 11. Frame Glass Panel x 1 A | Y. Magnetic Upright Cap x 1 BB2107 |
| 3. Screw x 6 (4 x 30mm) BB4202 | 12. Short Upright seal x 1 BB3203 | Z. Wall profile Cap x 1 BB2201 |
| 4. Screw cover cap x 12 BB2202 | 13. Moving Glass Panel x 1 B | |
| 5. Screw x 6 (4 x 12mm) BB4203 | 14. Rollers x 4 BB6201 | |
| 6. Screw cap clip x 12 BB2203 | 15. Roller channels x 2 C | |
| 7. Long Upright seal x 1 BB3202 | 16. Knob x 1 BB6202 | |
| 8. Screw x 4 (4 x 30mm) BB4202 | 17. Wedge gasket x 1 BB3106 | |
| 9. Fixed panel Upright x 1 BB1102 | 18. Magnetic Seal x 1 BB3204 | |

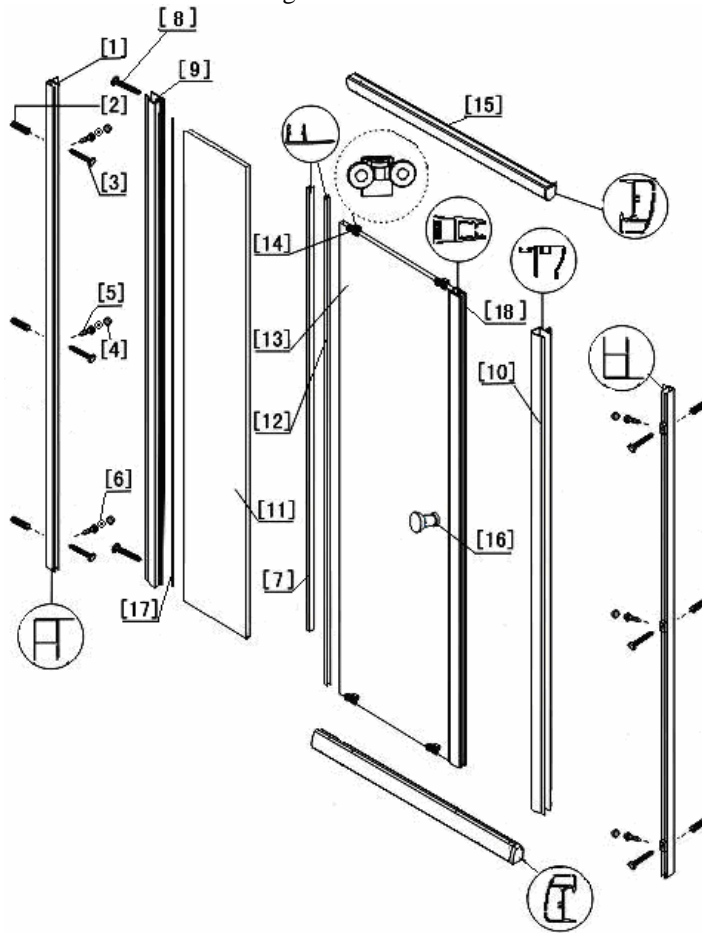

Fig 1

Tools Required

- | | | |
|-------------|------------------------|------------------------|
| Power Drill | Philips #2 Screwdriver | Drill Bits, 3.5mm, 6mm |
| Hammer | Tape measure | Pencil |
| 8mm Spanner | Spirit Level | |

Inspect Contents

Please read these installation instructions carefully before attempting to install the products. Check that none of the parts or fittings are missing and that nothing is damaged. If anything is missing or damaged, contact your place of purchase/retailer within 5 working days.

Note: Ensure the tray is level and sealed on all sides before proceeding with the fitting of the enclosure.

Installation

1. Plumb the wall profiles **BB1201** using the vertical element of the spirit level.
2. Mark holes on wall, drill using a 6mm masonry bit and fit wall plugs **BB6204**.
3. Using the Screw **BB4202**, fix wall profiles to wall. **Fig 2**.
4. Assemble the bottom roller channel **C** to the upright profile **BB1102** using one screw **BB4202**. Insert the fixed glass panel **A** into bottom roller channel and the upright profile. Fix the top roller channel **C** to the glass and upright profile fix with screw **BB4202** **Fig 3**.
5. Assemble the magnetic upright **BB1103** to the top and bottom roller channels using the screws **BB4202**. **Fig 3**
6. Push in the wedge gasket **BB3106** into the frame on the inside where the glass inserts into the upright profile. Ensure there is no gap at the bottom. Cut to length if required. Place the frame into the wall profiles.

NOTE: If you have a finish tile measurement near the minimum adjustment:

Step 1. Only fix one wall profile to the wall.

Step 2: Insert the second wall profile into the frame,.

Step 3: place the frame onto the tray, insert into the fixed wall profile.

Step 4: adjust the unfixed wall profile out to the wall and fix.

7. Assemble the 4 rollers **BB6201** onto the moving glass panel **B** by opening the covers on the roller bracket and loosening the nuts on all 4 rollers on each door. Ensure the rollers are hanging the correct way. **Insert Fig 4**.
8. Fit moving panel **B** to the top and bottom channels **C**. **Fig 4**.
9. Ensure the door is level & frame centred between wall profiles.
10. From inside the enclosure, using the 3.5mm steel drill bit, drill through the fixed panel profile into the wall profile and secure with Screws **BB4203**, with Screw cover caps **BB2202** and screw cap clips **BB2203**.
11. Fit the magnetic seal **BB3204** to the closing edge of the moving panel.
12. Fit the long upright seal **BB3202** to the back edge of the moving panel **B**. (wiper blade facing out).
13. Fit the short upright seal **BB3203** to the edge of the fixed panel **A** (wiper blade facing in).
14. Align the door by loosening and tightening the different roller, to ensure the magnetic seals are sealing evenly along the full length of the door and the sliding action is smooth.
15. Fit the door knob **BB6202** using the plastic washers and threaded bar.
16. Fit all profile cover caps.

Sealing, Fig 5 & 6

Inside: (Dashed line)

When installation is complete seal the joint between the wall profile and the wall, top to bottom on the inside only.

DO NOT SEAL where the wall profile sits on the tray. DO NOT SEAL any parts of the enclosure that sits on the tray on the inside of the enclosure.

Outside (Black line)

From outside the enclosure SEAL the joint between the bottom roller channel and the shower tray, full length from left to right side and approx 50mm up on the wall profile on either side. Seal the frame joints on the bottom. Seal around the chrome cap under the vertical seal where the glass sits in the bottom roller channel. **Fig 6**

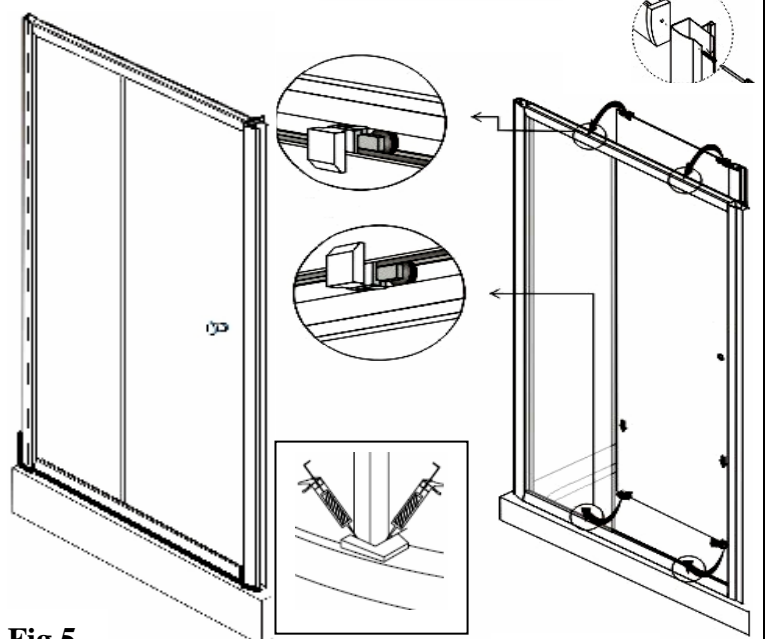
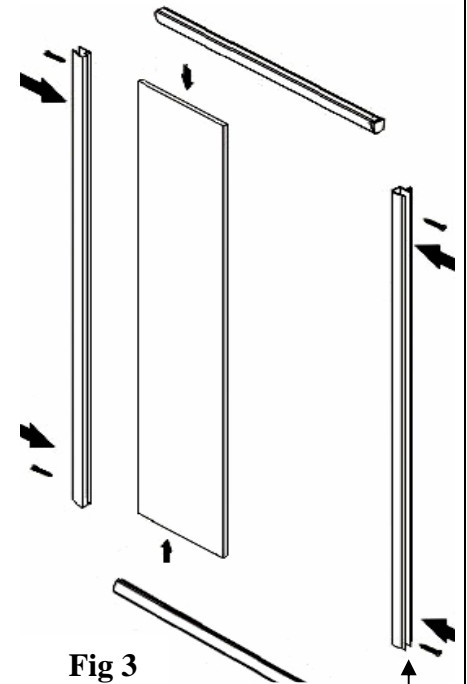
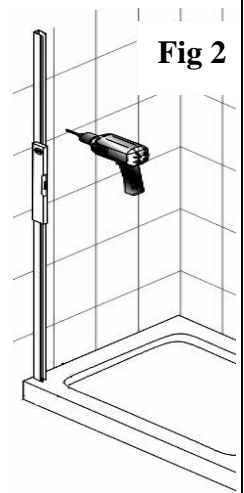

Fig 5

Fig 6

Fig 4

DO NOT USE FOR 24 HOURS AFTER SEALING